

CERTIFIED LAND CORNER RECORDATION

DESCRIPTION OF CORNER EVIDENCE FOUND, AND ORIGINAL RECORD (if known)

LOCATION $\frac{1}{4}$ S.30 $\frac{1}{4}$ S.31 T.15N., R.69W. 6th P.M.	No evidence found. Corner re-established by single proportionate measurement. G.L.O. record - Granite boulder, 16 x 12 x 4. Contract survey by Henry G. Hay in 1871.
--	--

DESCRIPTION OF MONUMENT AND ACCESSORIES ESTABLISHED TO PERPETUATE THE ORIGINAL LOCATION OF THIS CORNER:

At the corner: Set a $1\frac{1}{2}$ " dia. x 30" long iron pipe with brass cap.
 Accessories: Raised a rock mound, 2 feet north of corner monument.

SKETCH, WITH COURSE AND DISTANCE TO ADJACENT CORNER IF DETERMINED IN THIS SURVEY.
 (May Sketch or Paste Reproduction on Reverse Side.)

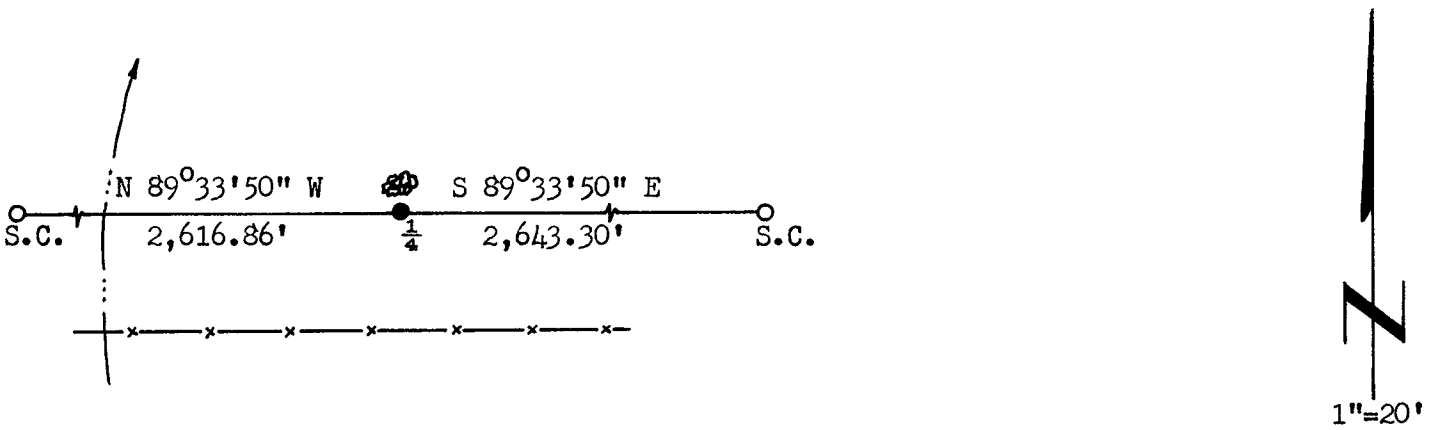

Brass cap set 6" above ground.

Brass cap stamped:

T.15N. R.69W.

$\frac{1}{4}$ S.30
 $\frac{1}{4}$ S.31

LS 519 1972

I, R.L. Hudson certify that I have carefully performed ~~or reviewed~~ the work done on the diagrammed corner as reported on this recordation form and approve the same.

R.L. Hudson
 Signature of Surveyor

Wyoming L.S. No. 519
 Registration No.

STATE OF WYOMING,
 Office of Clerk and Recorder,
 County of Sarawie

This "corner record" was filed for record on the 30th day of October, 1972, was noted on the cross-index plat and is assigned page No. 1569, in book No. ONE

John D. Williams
 County Official

Cross Index No. _____	T. _____	R. _____	Mer. _____
_____	T. _____	R. _____	Mer. _____
_____	T. _____	R. _____	Mer. _____
_____	T. _____	R. _____	Mer. _____
_____	T. _____	R. _____	Mer. _____
_____	T. _____	R. _____	Mer. _____
_____	T. _____	R. _____	Mer. _____

the State of Wyoming } SS
County of Laramie

This instrument was filed for record
at 2:23 o'clock P.M. on the
20th day of October 1928
A. J. 10 and duly recorded in
Book _____ of page _____

[Handwritten Signature]

County Clerk & Ex-Officio Register of Deeds
Deputy

BY _____